



June 6, 2024

TO: Holders List

SUBJECT: 072112 PCT STRAD BAY ROOF AND HUSKY MAINTENANCE TOWER ROOF REPLACEMENTS

Responses to Bid Questions # 02

1. BIDDER QUESTION (email 5-17-24)

Does the above project currently have a mobilization date, and completion date? Also, does there happen to be any union or labor requirements?

RESPONSE (5/22/24)

The contract time begins at contract execution and the contractor shall achieve substantial completion of the entire work not later than 175 calendar days from the execution of the contract: Reference Specification Section 00 52 00 & 00 72 00.

Note: Contractor will also be responsible for weather protections as outlined in 02 07 00, 07 53 00, and 07 92 00.

Union and/or labor requirements are outlined in Section 00 72 00 and 00 73 46.

2. BIDDER QUESTION (Q-002095 5-14-24)

I want to bid on this one, but I see the products you are using, and they won't certify anyone to use these products unless they sell hundreds of thousands of materials to the contractor per year. I have tried. However, we are Duro-Last PVC certified installers and have used it on the sea tac airport, City of Tillamook City Hall, John Jacob Astor School, Coastguard, DFW and many more. All with 20 year no dollar limit warranties. If I provide a substitution request will Duro-Last be considered for this project?

RESPONSE (5/22/24)

Substitution requests for the PVC membrane will be considered providing they conform to Specification Section 00 26 00 & Section 07 53 00. Most notably, the manufacturer will need to submit a letter attesting the material meets the requirements as specified in 07 53 00, 1.02.

RESPONSE (5/29/24)

The manufacturers noted below as “Approved” are approved, subject to full compliance with the Contract Documents. Bidders are cautioned that the listing of a manufacturer in the addendum does not necessarily grant approval of a manufacturer’s standard production product, but rather the manufacturer is approved to bid their product. Bidders are reminded that by bidding these substitutions, the product submittals and shop drawings are required and subject to review for conformance and compliance with the contract documents.

SECTION	DESCRIPTION	MANUFACTURER	RESPONSE/COMMENTARY
07 5300	PVC Roofing	Durolast: Duro-Tuff 60-mil	Approved*

*Approval by addendum or under section 07 53 00 does not waive requirement for the field membrane thickness verification described in section 07 53 00 paragraph 1.09, or other requirements specified in section 07 53 00.

3. BIDDER QUESTION (Q-002102 5-23-24)

I would like to submit a substitution/inclusion request for Duro-Last DuroFleece 60-mil minimum Roof System WHITE.

RESPONSE (6/03/24)

See revisions to paragraph 2.02-A in specification 07 53 00 – Single Ply Membrane Roofing (PVC) to be issued in Addendum #02. Fleece-back membrane is not required for any portion of this project. Submit substitution requests in accordance with Section 00 26 00 – Substitution Procedures.

4. BIDDER QUESTION (Q-002103 5-23-24)

I would like to submit a substitution/inclusion request for the 60-mil minimum thickness PVC FB Roofing Membrane System.

RESPONSE (6/03/24)

See revisions to paragraph 2.02-A in specification 07 53 00 – Single Ply Membrane Roofing (PVC) to be issued in Addendum #02. Fleece-back membrane is not required for any portion of this project. Submit substitution requests in accordance with Section 00 26 00 – Substitution Procedures.

5. BIDDER QUESTION (Q-002106 5-28-24)

Will there be a link to listen to the bid opening or is it live/in person only? Thank you.

RESPONSE (5/30/24)

In person only.

6. BIDDER QUESTION (Q-002107 5-28-24)

Please confirm Scope of Demolition on the Strad Bay Roof Area.

Plans and Specifications call for existing metal roofing to be removed, please confirm.

RESPONSE (6/03/24)

Confirmed, existing standing seam roof panels to be removed at the hatched area per keynote #1 on sheet AD1.00. New roof assembly to be installed over existing structural metal decking per detail 2/A1.10.

7. BIDDER QUESTION (Q-002109 5-29-24)

Fall Protection Contractors Have Questions

I had a look at the documents and there are a couple of issues.

The specification 11 01 00 – Fall Protection Systems has contradicting requirements - Could you please Clarify.

- o Paragraph 1.01-A.-3. calls for load testing of welded post anchors. However, this is contradicted in paragraph 2.02 as it calls for an 18" roof anchor installed on metal deck.

- o Paragraph 2.02 calls for a 2-Way Standing Seam Roof Clamp. This is typically used as a temporary anchor on SSMR during construction and not as a permanent roof anchor.

- o Paragraph 2.04 it calls for horizontal lifeline systems with the Basis of Design SS versions of Guardian Metal Energy Absorber Systems. These types of systems use 3/8" diameter cable. However, the spec calls for a 7x7, 5/16" (8mm) cable which is the wrong diameter for these systems.

- o Paragraphs 3.02-C. and 3.03-C. call for roof anchors to be proof load tested. And per details 7 & 8 on page A5.10 the roof anchors are screwed down to 3/4" CDX plywood. However approved manufacturers like Super Anchor Safety specifically state to NOT proof load roof anchors with this type of connection detail.

We proof load all of our rigid roof anchors and the provided connection detail would make this impassible.

Alternatively, we could provide you with a system using Tip-Over Style Force Management Anchors.

RESPONSE (6/03/24)

RE: Paragraph 1.01-A.-3 - Additional clarification to be issued in Addendum #2.

RE: Paragraph 2.02 - This will be revised to a permanent style clamp in Addendum #2.

RE: Paragraph 2.04 - 3/8" diameter is the standard cable provided by Guardian, however cable as small as 3/16" diameter can be used with the lifeline connection kit. The lifeline specified is a vinyl coated "safety yellow" cable provided separately from the lifeline manufacturer. No changes to be made.

RE: Paragraphs 3.02-C. and 3.03-C – Additional clarification to be issued in Addendum #2.

8. BIDDER QUESTION (Email Dated 5/27/24)

- 1) will get you an e mail from my rep stating that Duro-Last meets or exceeds the proposed product.
- 2) Will the roofing be removed on either building or not?
- 3) At the bid walk we were told it won't, but the plans are saying it will.
- 4) I see décor ribs are to be installed. What is the purpose of this? These roofs are not visible from the ground.

- 5) what is the purpose of raising the ladder? Does it mean temporarily raise it to change the coping metal?
- 6) Why are we using fleece backed material? This costs more and has no benefit. This is usually used when glueing over torch down roofing.

RESPONSE (6/03/24)

1. The demolition at the PCT Strad Bay roof area consists of the removal and disposal of the existing standing seam metal roofing panels. Expanded Polystyrene (EPS) Insulation will be fluted to fit into the underlying metal deck ribs, per Detail 2 on Sheet A1.10. See Details 3 & 8 on Sheet AD9.10 to reference metal roof panels to be demolished. See Detail 5 & 6 on Sheet AD9.10 to reference underlying metal deck to be fluted with EPS insulation (as viewed from the bottom).
2. Demolition of the roofing panels is not part of the scope of work at Husky.
3. Contract documents take precedence over any discussions held during the pre-bid walk unless formally modified in writing through addendum.
4. Decor ribs have been removed from the scope of work per Addendum No. 1.
5. The Roof Access Ladder at PCT will be permanently raised to accommodate depth of the new roofing assembly. Refer to details 8/AD9.10 and 10/A5.10.
6. See revisions to paragraph 2.02-A in specification 07 53 00 – Single Ply Membrane Roofing (PVC) to be issued in Addendum #02. Fleeceback membrane is not required for any portion of this project. Submit substitution requests in accordance with Section 00 26 00 – Substitution Procedures.

9. BIDDER QUESTION (Email Dated 5/27/24)

There are conflicting drawings. On A1.10 I see the roof assembly for PCT described as shown here.

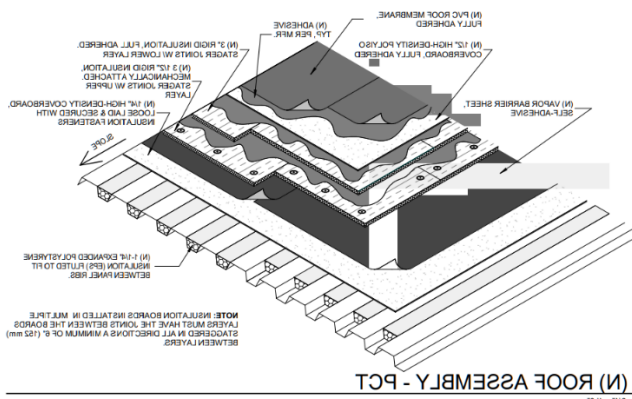

And on A1.20 I see Husky showing as this.

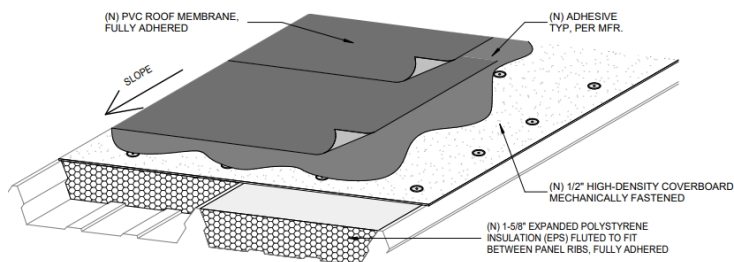

(N) ROOF ASSEMBLY - HUSKY

NTS

And then on A5.10 it shows this.

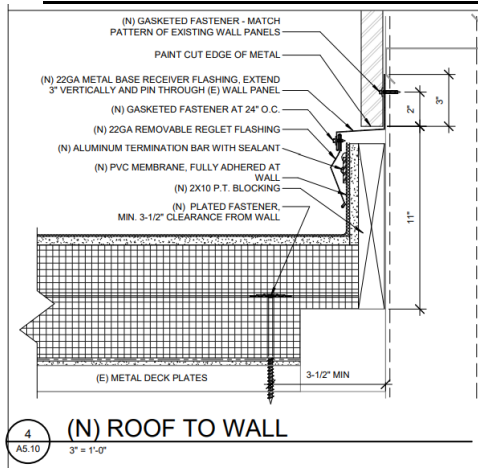

Please clarify this. Also need to know why we are installing insulation on the parapet wall and cutting the ladder to extend it. This is not necessary. Please advise.

RESPONSE (6/03/24)

Roof assemblies are not conflicting, they are different for each building – refer to the drawings. PCT roof details are shown on drawing sheet A5.10, with Husky roof details on sheet A5.20. There are no parapet walls on the structure, ladder modifications are required to suit the depth of the new roof assembly at PCT per detail 10/A5.10.

10. BIDDER QUESTION (Email Dated 5/23/24)

I want to use Duro-Last PVC on the PCT Strad Bay Roof and Husky Maintenance Tower Roof Replacements project. We used it on the elevator towers at the Sea Tac Airport. Will this be okay?

RESPONSE (6/03/24)

See revisions to paragraph 2.02-A in specification 07 53 00 – Single Ply Membrane Roofing (PVC) to be issued in Addendum #02. Fleeceback membrane is not required for any portion of this project. Duro-Last “Duro-Tuff” 60-mil PVC membrane is acceptable as reviewed in forthcoming Addendum #02.

11. BIDDER QUESTION (Email dated 6/3/24)

Are the scopes on the two roofs switched around?

RESPONSE (6/04/24)

No. The scopes are correct. Clarification can be found in the response to Bidder Questions #6, #8 and #9.